

**Application to vary a premises licence under the Licensing Act 2003**

**PLEASE READ THE FOLLOWING INSTRUCTIONS FIRST**

Before completing this form please read the guidance notes at the end of the form.  
If you are completing this form by hand please write legibly in block capitals. In all cases ensure that your answers are inside the boxes and written in black ink. Use additional sheets if necessary.  
You may wish to keep a copy of the completed form for your records.

I/We **DAN MANDABA KITUNO**

*(Insert name(s) of applicant)*

being the premises licence holder, apply to vary a premises licence under section 34 of the Licensing Act 2003 for the premises described in Part 1 below

<b>Premises licence number</b> PL0002
--

**Part 1 – Premises Details**

<b>Postal address of premises or, if none, ordnance survey map reference or description</b> THE NEW BAR SERENGETI 124 WELLINGBOROUGH ROAD			
<b>Post town</b>	NORTHAMPTON	<b>Post code</b>	NN1 4DR

<b>Telephone number at premises (if any)</b>	
<b>Non-domestic rateable value of premises</b>	£3400

**Part 2 – Applicant details**

<b>Daytime contact telephone number</b>			
<b>E-mail address (optional)</b>			
<b>Current postal address if different from premises address</b>			
<b>Post Town</b>		<b>Postcode</b>	

**Part 3 - Variation**

Please tick yes

Do you want the proposed variation to have effect as soon as possible?

If not do you want the variation to take effect from

Day		Month		Year	
<input type="text"/>	<input type="text"/>	<input type="text"/>	<input type="text"/>	<input type="text"/>	<input type="text"/>

**Please describe briefly the nature of the proposed variation (Please see guidance note 1)  
TO EXTEND THE EXISTING HOURS AND FOR THE ADDITION OF FURTHER LICENSABLE  
ACTIVITIES**

If your proposed variation would mean that 5,000 or more people are expected to attend the premises at any one time, please state the number expected to attend

#### Part 4 Operating Schedule

Please complete those parts of the Operating Schedule below which would be subject to change if this application to vary is successful.

##### Provision of regulated entertainment

Please tick yes

- |   |                                     |
|---|-------------------------------------|
| a) plays (if ticking yes, fill in box A)  | <input type="checkbox"/>            |
| b) films (if ticking yes, fill in box B)  | <input type="checkbox"/>            |
| c) indoor sporting events (if ticking yes, fill in box C)   | <input type="checkbox"/>            |
| d) boxing or wrestling entertainment (if ticking yes, fill in box D)  | <input type="checkbox"/>            |
| e) live music (if ticking yes, fill in box E)   | <input checked="" type="checkbox"/> |
| f) recorded music (if ticking yes, fill in box F)   | <input checked="" type="checkbox"/> |
| g) performances of dance (if ticking yes, fill in box G)  | <input checked="" type="checkbox"/> |
| h) anything of a similar description to that falling within (e), (f) or (g) (if ticking yes, fill in box H) | <input checked="" type="checkbox"/> |

##### Provision of entertainment facilities:

- |   |                                     |
|---|-------------------------------------|
| i) making music (if ticking yes, fill in box I)   | <input checked="" type="checkbox"/> |
| j) dancing (if ticking yes, fill in box J)  | <input checked="" type="checkbox"/> |
| k) entertainment of a similar description to that falling within (i) or (j) (if ticking yes, fill in box K) | <input checked="" type="checkbox"/> |

Provision of late night refreshment (if ticking yes, fill in box L)

Sale by retail of alcohol (if ticking yes, fill in box M)

In all cases complete boxes N, O and P

**A**

Plays Standard days and timings (please read guidance note 6)			Will the performance of a play take place <u>indoors or outdoors or both – please tick</u> (please read guidance note 2)	Indoors	<input type="checkbox"/>
				Outdoors	<input type="checkbox"/>
				Both	<input type="checkbox"/>
Day	Start	Finish			
Mon			<b>Please give further details here</b> (please read guidance note 3)		
Tue					
Wed			<b>State any seasonal variations for performing plays</b> (please read guidance note 4)		
Thur					
Fri			<b>Non standard timings. Where you intend to use the premises for the performance of plays at different times to those listed in the column on the left, please list</b> (please read guidance note 5)		
Sat					
Sun					

**B**

<b>Films</b> Standard days and timings (please read guidance note 6)			<b>Will the exhibition of films take place indoors or outdoors or both – please tick</b> (please read guidance note 2)	Indoors	<input type="checkbox"/>
				Outdoors	<input type="checkbox"/>
				Both	<input type="checkbox"/>
Day	Start	Finish			
Mon			<b>Please give further details here</b> (please read guidance note 3)		
Tue			<b>State any seasonal variations for the exhibition of films</b> (please read guidance note 4)		
Wed			<b>Non standard timings. Where you intend to use the premises for the exhibition of films at different times to those listed in the column on the left, please list</b> (please read guidance note 5)		
Thur					
Fri					
Sat					
Sun					

**C**

Indoor sporting events Standard days and timings (please read guidance note 6)			<u>Please give further details</u> (please read guidance note 3)
Day	Start	Finish	
Mon			
Tue			<u>State any seasonal variations for indoor sporting events</u> (please read guidance note 4)
Wed			<u>Non standard timings. Where you intend to use the premises for indoor sporting events at different times to those listed in the column on the left, please list</u> (please read guidance note 5)
Thur			
Fri			
Sat			
Sun			

**D**

<b>Boxing or wrestling entertainments</b> Standard days and timings (please read guidance note 6)			<b><u>Will the boxing or wrestling entertainment take place indoors or outdoors or both – please tick</u></b> (please read guidance note 2)	Indoors	<input type="checkbox"/>
				Outdoors	<input type="checkbox"/>
				Both	<input type="checkbox"/>
Day	Start	Finish	<b><u>Please give further details here</u></b> (please read guidance note 3)		
Mon					
Tue					
Wed			<b><u>State any seasonal variations for boxing or wrestling entertainment</u></b> (please read guidance note 4)		
Thur					
Fri			<b><u>Non standard timings. Where you intend to use the premises for boxing or wrestling entertainment at different times to those listed in the column on the left, please list</u></b> (please read guidance note 5)		
Sat					
Sun					

**E**

<b>Live music</b> Standard days and timings (please read guidance note 6)			<b>Will the performance of live music take place indoors or outdoors or both – please tick</b> (please read guidance note 2)	Indoors	<input checked="" type="checkbox"/>
				Outdoors	<input type="checkbox"/>
				Both	<input type="checkbox"/>
<b>Day</b>	<b>Start</b>	<b>Finish</b>	<b>Please give further details here</b> (please read guidance note 3) FOR THE PROVISION OF THE LICENSABLE ACTIVITY, SHOULD IT BE SO REQUIRED, FOR SPECIAL EVENTS SUCH AS NATIONAL CELEBRATIONS OF INDEPENDENCE DAYS OR PRIVATE BOOKINGS  <b>State any seasonal variations for the performance of live music</b> (please read guidance note 4) SHOULD ANY OF THE EXISTING STATED CELEBRATION DAYS/ SEASONAL VARIATIONS FALL SUNDAY, MONDAY, TUESDAY OR WEDNESDAY, THE LICENSABLE ACTIVITY WILL BE REQUIRED UNTIL 01.30HRS  <b>Non standard timings. Where you intend to use the premises for the performance of live music at different times to those listed in the column on the left, please list</b> (please read guidance note 5)		
Mon	11.00	23.30			
Tue	11.00	23.30			
Wed	11.00	23.30			
Thur	11.00	01.30			
Fri	11.00	01.30			
Sat	11.00	01.30			
Sun	11.00	23.30			



**F**

<b>Recorded music</b> Standard days and timings (please read guidance note 6)			<b>Will the playing of recorded music take place indoors or outdoors or both – please tick</b> (please read guidance note 2)	Indoors	<input checked="" type="checkbox"/>
				Outdoors	<input type="checkbox"/>
				Both	<input type="checkbox"/>
<b>Day</b>	<b>Start</b>	<b>Finish</b>	<b>Please give further details here</b> (please read guidance note 3) FOR THE PROVISION OF THE LICENSABLE ACTIVITY, SHOULD IT BE SO REQUIRED, FOR SPECIAL EVENTS SUCH AS NATIONAL CELEBRATIONS OF INDEPENDENCE DAYS OR PRIVATE BOOKINGS		
Mon	11.00	23.30			
Tue	11.00	23.30	<b>State any seasonal variations for the playing of recorded music</b> (please read guidance note 4) SHOULD ANY OF THE EXISTING STATED CELEBRATION DAYS/ SEASONAL VARIATIONS FALL SUNDAY, MONDAY, TUESDAY OR WEDNESDAY, THE LICENSABLE ACTIVITY WILL BE REQUIRED UNTIL 01.30HRS		
Wed	11.00	23.30			
Thur	11.00	01.30	<b>Non standard timings. Where you intend to use the premises for the playing of recorded music at different times to those listed in the column on the left, please list</b> (please read guidance note 5)		
Fri	11.00	01.30			
Sat	11.00	01.30			
Sun	11.00	23.30			

**G**

<b>Performances of dance</b> Standard days and timings (please read guidance note 6)			<b>Will the performance of dance take place indoors or outdoors or both – please tick</b> (please read guidance note 2)	Indoors	<input checked="" type="checkbox"/>
				Outdoors	<input type="checkbox"/>
				Both	<input type="checkbox"/>
<b>Day</b>	<b>Start</b>	<b>Finish</b>	<b>Please give further details here</b> (please read guidance note 3) FOR THE PROVISION OF THE LICENSABLE ACTIVITY, SHOULD IT BE SO REQUIRED, FOR SPECIAL EVENTS SUCH AS NATIONAL CELEBRATIONS OF INDEPENDENCE DAYS OR PRIVATE BOOKINGS		
Mon	11.00	23.30			
Tue	11.00	23.30	<b>State any seasonal variations for the performance of dance</b> (please read guidance note 4) SHOULD ANY OF THE EXISTING STATED CELEBRATION DAYS/ SEASONAL VARIATIONS FALL SUNDAY, MONDAY, TUESDAY OR WEDNESDAY, THE LICENSABLE ACTIVITY WILL BE REQUIRED UNTIL 01.30HRS		
Wed	11.00	23.30			
Thur	11.00	01.30	<b>Non standard timings. Where you intend to use the premises for the performance of dance at different times to those listed in the column on the left, please list</b> (please read guidance note 5)		
Fri	11.00	01.30			
Sat	11.00	01.30			
Sun	11.00	23.30			

H

<b>Anything of a similar description to that falling within (e), (f) or (g)</b> Standard days and timings (please read guidance note 6)			<b>Please give a description of the type of entertainment you will be providing</b>		
Day	Start	Finish	<b>Will this entertainment take place indoors or outdoors or both – please tick</b> (please read guidance note 2)	Indoors	<input checked="" type="checkbox"/>
Mon	11.00	23.30		Outdoors	<input type="checkbox"/>
				Both	<input type="checkbox"/>
Tue	11.00	23.30	<b>Please give further details here</b> (please read guidance note 3) <b>FOR THE PROVISION OF THE LICENSABLE ACTIVITY, SHOULD IT BE SO REQUIRED, FOR SPECIAL EVENTS SUCH AS NATIONAL CELEBRATIONS OF INDEPENDENCE DAYS OR PRIVATE BOOKINGS</b>		
Wed	11.00	23.30			
Thur	11.00	01.30	<b>State any seasonal variations for entertainment of a similar description to that falling within (e), (f) or (g)</b> (please read guidance note 4) <b>SHOULD ANY OF THE EXISTING STATED CELEBRATION DAYS/ SEASONAL VARIATIONS FALL SUNDAY, MONDAY, TUESDAY OR WEDNESDAY, THE LICENSABLE ACTIVITY WILL BE REQUIRED UNTIL 01.30HRS</b>		
Fri	11.00	01.30			
Sat	11.00	01.30	<b>Non standard timings. Where you intend to use the premises for the entertainment of a similar description to that falling within (e), (f) or (g) at different times to those listed in the column on the left, please list</b> (please read guidance note 5)		
Sun	11.00	23.30			

<b>Provision of facilities for making music</b> Standard days and timings (please read guidance note 6)			<b><u>Please give a description of the facilities for making music you will be providing</u></b>	
			<b><u>Will the facilities for making music be indoors or outdoors or both – please tick</u></b> (please read guidance note 2)	
			Indoors	<input checked="" type="checkbox"/>
			Outdoors	<input type="checkbox"/>
			Both	<input type="checkbox"/>
Day	Start	Finish	<b><u>Please give further details here</u></b> (please read guidance note 3) FOR THE PROVISION OF THE LICENSABLE ACTIVITY, SHOULD IT BE SO REQUIRED, FOR SPECIAL EVENTS SUCH AS NATIONAL CELEBRATIONS OF INDEPENDENCE DAYS OR PRIVATE BOOKINGS	
Mon	11.00	23.30		
Tue	11.00	23.30	<b><u>State any seasonal variations for the provision of facilities for making music</u></b> (please read guidance note 4) SHOULD ANY OF THE EXISTING STATED CELEBRATION DAYS/ SEASONAL VARIATIONS FALL SUNDAY, MONDAY, TUESDAY OR WEDNESDAY, THE LICENSABLE ACTIVITY WILL BE REQUIRED UNTIL 01.30HRS	
Wed	11.00	23.30		
Thur	11.00	01.30	<b><u>Non standard timings. Where you intend to use the premises for provision of facilities for making music at different times to those listed in the column on the left, please list</u></b> (please read guidance note 5)	
Fri	11.00	01.30		
Sat	11.00	01.30		
Sun	11.00	23.30		

J

<b>Provision of facilities for dancing</b> Standard days and timings (please read guidance note 6)			<b>Will the facilities for dancing be indoors or outdoors or both – please tick</b> (see guidance note 2)	
			Indoors	<input checked="" type="checkbox"/>
			Outdoors	<input type="checkbox"/>
			Both	<input type="checkbox"/>
			<b>Please give a description of the facilities for dancing you will be providing</b>	
<b>Day</b>	<b>Start</b>	<b>Finish</b>	<b>Please give further details here</b> (please read guidance note 3) <b>FOR THE PROVISION OF THE LICENSABLE ACTIVITY, SHOULD IT BE SO REQUIRED, FOR SPECIAL EVENTS SUCH AS NATIONAL CELEBRATIONS OF INDEPENDENCE DAYS OR PRIVATE BOOKINGS</b>  <b>State any seasonal variations for providing dancing facilities</b> (please read guidance note 4) <b>SHOULD ANY OF THE EXISTING STATED CELEBRATION DAYS/ SEASONAL VARIATIONS FALL SUNDAY, MONDAY, TUESDAY OR WEDNESDAY, THE LICENSABLE ACTIVITY WILL BE REQUIRED UNTIL 01.30HRS</b>  <b>Non standard timings. Where you intend to use the premises for the provision of facilities for dancing at different times to those listed in the column on the left, please list</b> (please read guidance note 5)	
Mon	11.00	23.30		
Tue	11.00	23.30		
Wed	11.00	23.30		
Thur	11.00	01.30		
Fri	11.00	01.30		
Sat	11.00	01.30		
Sun	11.00	23.30		

**K**

<b>Provision of facilities for entertainment of a similar description to that falling within i or j</b> Standard days and timings (please read guidance note 6)			<b>Please give a description of the type of entertainment facility you will be providing</b>  		
<b>Day</b>	<b>Start</b>	<b>Finish</b>	<b>Will the entertainment facility be indoors or outdoors or both – please tick</b> (please read guidance note 2)	Indoors	<input checked="" type="checkbox"/>
Mon	11.00	23.30		Outdoors	<input type="checkbox"/>
				Both	<input type="checkbox"/>
Tue	11.00	23.30	<b>Please give further details here</b> (please read guidance note 3) FOR THE PROVISION OF THE LICENSABLE ACTIVITY, SHOULD IT BE SO REQUIRED, FOR SPECIAL EVENTS SUCH AS NATIONAL CELEBRATIONS OF INDEPENDENCE DAYS OR PRIVATE BOOKINGS		
Wed	11.00	23.30			
Thur	11.00	01.30	<b>State any seasonal variations for the provision of facilities for entertainment of a similar description to that falling within i or j</b> (please read guidance note 4) SHOULD ANY OF THE EXISTING STATED CELEBRATION DAYS/ SEASONAL VARIATIONS FALL SUNDAY, MONDAY, TUESDAY OR WEDNESDAY, THE LICENSABLE ACTIVITY WILL BE REQUIRED UNTIL 01.30HRS		
Fri	11.00	01.30			
Sat	11.00	01.30	<b>Non standard timings. Where you intend to use the premises for the provision of facilities for entertainment of a similar description to that falling within i or j at different times to those listed in the column on the left, please list</b> (please read guidance note 5)		
Sun	11.00	23.30			

L

Late night refreshment Standard days and timings (please read guidance note 6)			Will the provision of late night refreshment take place indoors or outdoors or both – please tick (please read guidance note 2)	Indoors	<input checked="" type="checkbox"/>
Day	Start	Finish		Outdoors	<input type="checkbox"/>
Mon	23.00	23.30	<b>Please give further details here</b> (please read guidance note 3)	Both	<input type="checkbox"/>
Tue	23.00	23.30			
Wed	23.00	23.30	<b>State any seasonal variations for the provision of late night refreshment</b> (please read guidance note 4) SHOULD ANY OF THE EXISTING STATED CELEBRATION DAYS/ SEASONAL VARIATIONS FALL SUNDAY, MONDAY, TUESDAY OR WEDNESDAY, THE LICENSABLE ACTIVITY WILL BE REQUIRED UNTIL 01.30HRS		
Thur	23.00	01.30			
Fri	23.00	01.30	<b>Non standard timings. Where you intend to use the premises for the provision of late night refreshment at different times, to those listed in the column on the left, please list</b> (please read guidance note 5)		
Sat	23.00	01.30			
Sun	23.00	23.30			

**M**

<b>Supply of alcohol</b> Standard days and timings (please read guidance note 6)			<b>Will the supply of alcohol be for consumption (Please tick box) (please read guidance note 7)</b>	On the premises	<input type="checkbox"/>
				Off the premises	<input type="checkbox"/>
				Both	<input checked="" type="checkbox"/>
<b>Day</b>	<b>Start</b>	<b>Finish</b>	<b>State any seasonal variations for the supply of alcohol</b> (please read guidance note 4) SHOULD ANY OF THE EXISTING STATED CELEBRATION DAYS/ SEASONAL VARIATIONS FALL SUNDAY, MONDAY, TUESDAY OR WEDNESDAY, THE LICENSABLE ACTIVITY WILL BE REQUIRED UNTIL 01.30HRS		
Mon	11.00	23.30			
Tue	11.00	23.30			
Wed	11.00	23.30			
Thur	11.00	01.30			
Fri	11.00	01.30			
Sat	11.00	01.30			
Sun	11.00	23.30	<b>Non-standard timings. Where you intend to use the premises for the supply of alcohol at different times to those listed in the column on the left, please list</b> (please read guidance note 5)		

**N**

**Please highlight any adult entertainment or services, activities, other entertainment or matters ancillary to the use of the premises that may give rise to concern in respect of children (please read guidance note 8)**  
 NONE



O

Hours premises are open to the public Standard days and timings (please read guidance note 6)			State any seasonal variations (please read guidance note 4) SHOULD ANY OF THE EXISTING STATED CELEBRATION DAYS/ SEASONAL VARIATIONS FALL SUNDAY, MONDAY, TUESDAY OR WEDNESDAY, THE HOURS OPEN TO THE PUBLIC WILL BE REQUIRED UNTIL 02.00HRS
Day	Start	Finish	
Mon	11.00	00.00	<u>Non standard timings. Where you intend the premises to be open to the public at different times from those listed in the column on the left, please list</u> (please read guidance note 5)
Tue	11.00	00.00	
Wed	11.00	00.00	
Thur	11.00	02.00	
Fri	11.00	02.00	
Sat	11.00	02.00	
Sun	11.00	00.00	

Please identify those conditions currently imposed on the licence which you believe could be removed as a consequence of the proposed variation you are seeking

Please tick yes

- I have enclosed the premises licence
- I have enclosed the relevant part of the premises licence

If you have not ticked one of these boxes please fill in reasons for not including the licence, or part of it, below

Reasons why I have failed to enclose the premises licence or relevant part of premises licence  
THE PREMSES LICENCE HAS ALREADY BEEN SUBMITTED TO THE COUNCIL BY MR  
KITUNO WITH A PREVIOUS APPLICATION.

**P** Describe any additional steps you intend to take to promote the four licensing objectives as a result of the proposed variation:

**a) General – all four licensing objectives (b,c,d,e) (please read guidance note 9)**

The DPS fully understands his role and responsibilities concerning the four licensing objectives obtained within the 2003 Licensing Act, a comprehensive breakdown of these objectives and how to ensure they are met are detailed below. The DPS will take full responsibility of ensuring all staff are trained and have full knowledge of all licensing issues concerning them under the 2003 Licensing Act including the Challenge 25 rule.

**b) The prevention of crime and disorder**

Client has a CCTV digital recording system with a minimum of 31 days recording capability to ensure the prevention of crime & disorder. The CCTV follows the DCMS guidelines for camera systems in licensed premises & will be in accordance with Police recommendations. All members of staff shall be trained to deal with suspicious customers efficiently. All CCTV recordings shall be available to local police immediately upon request. One member of staff shall be trained to keep the CCTV in full working order at all times. Where necessary, the premises shall employ the service of SIA trained door supervisors to monitor activity at the premises. The premises has a zero tolerance policy for the use of drugs and other illegal substances and notices are displayed at the premises to demonstrate this. The premises shall cease any licensable activity 30 minutes before the terminal to reduce the amount of patrons leaving the premises at the same time. The premises shall become a member of the Pubwatch Scheme.

**c) Public safety**

The installed & approved CCTV digital recording system of the premises with a minimum of 31 days recording capability will monitor all public safety issues. The DPS will be responsible for conducting a Fire Risk Assessment and also a Health & Safety Risk Assessment for the licensed premises. All notices in relation to public Health & Safety will be displayed at the premises. The DPS will also ensure the premises will be operated in line with the Health & Safety Act and any environmental health issues will be the responsibility of both the licence holder for the premises & the DPS. The premises shall offer a free phone service for any patrons wishing to hire a taxi for their onward journey. The premises shall only use a licensed private hire company for this service.

**d) The prevention of public nuisance**

The DPS/Premises licence holder fully understands that it is their duty to prevent their business causing any nuisance to any local residents or businesses. They will monitor the external premises area in relation to any anti-social behaviour or public nuisance. The premises will only accept trade deliveries or rubbish collections during normal working hours. The DPS will also monitor the exterior of the premises to ensure litter is kept to a minimum. In the event of any anti-social behaviour both inside & outside of the premises, the DPS will make any CCTV recordings available to the local police immediately.

**e) The protection of children from harm**

The DPS will be responsible for ensuring all staff working within the premises will be fully trained and aware of the Challenge 25 rule. The premises will only accept valid forms of identification such as photo driving licence, passport and home office approved id cards displaying the national proof of age standard scheme (PASS hologram). All customers who look under the age of 25 shall be challenged to prove their identity when purchasing alcohol. The premises will also have a refusals register and all refusals by any member of staff shall be recorded. All children entering the premises shall be accompanied by a responsible adult at all times.

Please tick yes

- I have made or enclosed payment of the fee
- I have sent copies of this application and the plan to responsible authorities and others where applicable
- I understand that I must now advertise my application
- I have enclosed the premises licence or relevant part of it or explanation
- I understand that if I do not comply with the above requirements my application will be rejected

**IT IS AN OFFENCE, LIABLE ON CONVICTION TO A FINE UP TO LEVEL 5 ON THE STANDARD SCALE, UNDER SECTION 158 OF THE LICENSING ACT 2003 TO MAKE A FALSE STATEMENT IN OR IN CONNECTION WITH THIS APPLICATION**

**Part 5 – Signatures** (please read guidance note 10)

**Signature of applicant (the current premises licence holder) or applicant's solicitor or other duly authorised agent (please read guidance note 11). If signing on behalf of the applicant please state in what capacity.**

Signature	
Date	02/08/12
Capacity	Licensing Consultants on-Behalf-of-Client

**Where the premises licence is jointly held signature of 2nd applicant (the current premises licence holder) or 2nd applicant's solicitor or other authorised agent (please read guidance note 12). If signing on behalf of the applicant please state in what capacity.**

Signature	
Date	
Capacity	

**Contact name (where not previously given) and address for correspondence associated with this application (please read guidance note 13)**

PERSONAL LICENCE TRAINING LTD  
UNIT 3  
THE OAKS  
CLEWS ROAD

Post town	REDDITCH	Post code	B98 7ST
-----------	----------	-----------	---------

Telephone number (if any)	01527 544 780
---------------------------	---------------

If you would prefer us to correspond with you by e-mail your e-mail address (optional)	jo.taylor@personallicencetraining.co.uk
--	---

### Notes for Guidance

This application cannot be used to vary the licence so as to extend the period for which the licence has effect or to vary substantially the premises to which it relates. If you wish to make that type of change to the premises licence you should make a new premises licence application under section 17 of the Licensing Act 2003.

1. Describe the premises. For example the type of premises, its general situation and layout and any other information which could be relevant to the licensing objectives. Where your application includes off-supplies of alcohol and you intend to provide a place for consumption of these off-supplies you must include a description of where the place will be and its proximity to the premises.
2. Where taking place in a building or other structure please tick as appropriate. Indoors may include a tent.
3. For example state type of activity to be authorised, if not already stated, and give relevant further details, for example (but not exclusively) whether or not music will be amplified or unamplified.
4. For example (but not exclusively), where the activity will occur on additional days during the summer months.
5. For example (but not exclusively), where you wish the activity to go on longer on a particular day e.g. Christmas Eve.
6. Please give timings in 24 hour clock (e.g. 16:00) and only give details for the days of the week when you intend the premises to be used for the activity.
7. If you wish people to be able to consume alcohol on the premises please tick on, if you wish people to be able to purchase alcohol to consume away from the premises please tick off. If you wish people to be able to do both please tick both.
8. Please give information about anything intended to occur at the premises or ancillary to the use of the premises which may give rise to concern in respect of children regardless of whether you intend children to have access to the premises, for example (but not exclusively) nudity or semi-nudity, films for restricted age groups, the presence of gaming machines.
9. Please list here steps you will take to promote all four licensing objectives together.
10. The application form must be signed.
11. An applicant's agent (for example solicitor) may sign the form on their behalf provided that they have actual authority to do so.
12. Where there is more than one applicant, both applicants or their respective agents must sign the application form.
13. This is the address which we shall use to correspond with you about this application.

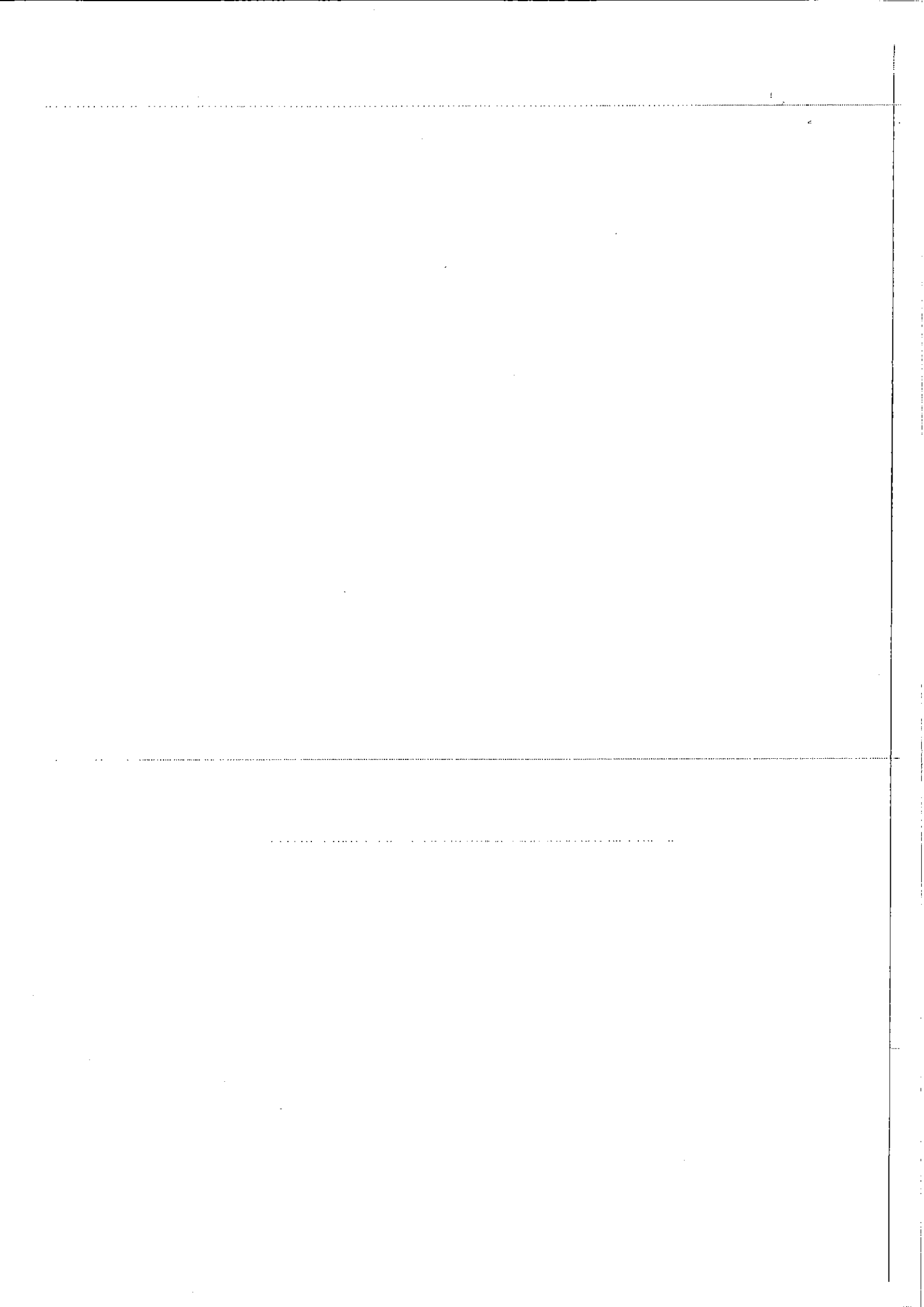

Date as Postmark

For the Attention of The Head of Licensing

Dear Sirs

Application to Vary an Existing Premises Licence

Please find enclosed an application to vary an existing premises licence. A copy of this application has been forwarded to all responsible authorities. Please note that an application for this premises was submitted last week but was subsequently withdrawn as it had not been completed correctly by the applicant. We have now been instructed to act on behalf of the applicant regarding this matter, hence the submission of a revised application.

Please confirm the date you received and accepted the application by e-mail or by letter to assure we have the correct information on the Blue Notices and in the newspaper advert.

If you have any queries regarding this application, then please do not hesitate to contact me to discuss further.

Kind Regards



Jo Taylor  
Licensing Team

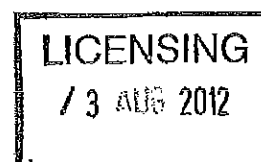





**Bill Edwards**

---

**From:** Paul Mallard  
**Sent:** 03 August 2012 13:38  
**To:** Licensing  
**Subject:** Bar Serengeti, 124 Wellingborough Road, Northampton, NN1 4DR.

**Follow Up Flag:** Follow up  
**Flag Status:** Completed

**M3PPRef:** WK/201205771  
**M3PPUnique:** 00000000D7CE844D48292C48A3FE2304C2D39DFE0700B7261325C2587B469E6CAA37C  
311556A0000000CFDED0000FB1932AD4C48954A91F8C638D1C93D3A00000000BC86000  
0

Dear All,

**Premises Licence - Extension of Hours  
Bar Serengeti, 124 Wellingborough Road, Northampton, NN1 4DR**

I refer to the amended application for the above premises.

Despite my previous comments the applicant has not provided any information regarding how he intends to control music noise on the premises so as to avoid a Public Nuisance.

Complaints have been received regarding loud music from these premises in the past, therefore, in view of the above, we are not satisfied that the music element of the application will not give rise to a Public Nuisance.

Therefore, Regulatory Services object to the application.

If the applicant can demonstrate, by way of a technical report from a competent person, that they will be able to operate without causing a Public Nuisance then we can withdraw the objection.

Regards,

P Mallard  
Senior Environmental Health Officer

Northampton Borough Council  
West Bridge Depot  
St James Mill Road  
NN5 5JW

01604 837649  
[pmallard@northampton.gov.uk](mailto:pmallard@northampton.gov.uk)

**Bill Edwards**

---

**From:** Paul Mallard  
**Sent:** 08 August 2012 15:22  
**To:** Licensing  
**Cc:** Louise Faulkner  
**Subject:** Bar Serengeti, 124 Wellingborough Road, Northampton, NN1 4DR - WK/201205771

**M3PPRef:** WK/201205771  
**M3PPUnique:** 00000000D7CE844D48292C48A3FE2304C2D39DFE0700B7261325C2587B469E6CAA37C311556A000000CFDED0000FB1932AD4C48954A91F8C638D1C93D3A00000000BCA40000

Dear All,

**Application for Licence variation - Bar Serengeti, 124 Wellingborough Road, Northampton, NN1 4DR**

further to my earlier emails concerning the above matter, I would advise you that we have now received a further complaint of loud music from the premises.

I shall be writing to the Licence Holder regarding the matter.

Regards,

P Mallard  
Senior Environmental Health Officer

Northampton Borough Council  
West Bridge Depot  
St James Mill Road  
NN5 5JW

01604 837649  
[pmallard@northampton.gov.uk](mailto:pmallard@northampton.gov.uk)



# Receipt

Northampton Borough Council

Mr D Kituno  
124 Wellingborough Road  
  
Northampton ,  
  
NN1 4BR .

Transaction Number 999997190545  
Authorisation Code 060269  
Merchant Number 89408191  
Terminal ID 27548297  
Card Type Visa Delta Debit Card  
Card Number \*\*\*\* \* 6004  
KEYED  
Expiry Date 0415

The following payments were accepted on 17 July 2012 at 10:45

Reference	Fund	Amount	Narrative
082409130	Miscellaneous Income	£100.00	Variation - Bar Serengeti

**Total Amount            £100.00**

Your account will be debited with the above amount. Please retain this receipt for your records.

To print this receipt, click the Print button on the toolbar. For a VAT receipt, click on the button below.

E-Mail Address   E-Mail Now



Copyright © 2012 Civica UK Ltd. All rights reserved.

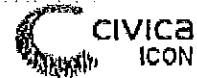

## Bill Edwards

---

**From:** licensing <licensing@northamptonshire.gov.uk>  
**Sent:** 13 August 2012 14:03  
**To:** Bill Edwards  
**Subject:** UNCLASSIFIED: RE: Licence Variation Application - 124 Wellingborough Rd, Northampton & New Premises License Application - Kailash, 161 Kettering Rdn Northampton

Dear Bill,

We have no comments to make on either application, I have however sent an advisory Part P letter to Kailash Ltd regarding staff training & records, use of refusals register & till prompts, display of posters etc.

Regards

*Rachel Bennett*

Senior Authorised Officer  
Trading Standards Service  
Wootton Hall Park  
Northampton  
NN4 0GB

Tel: 01604 362469

Fax: 01604 362425

[www.northamptonshire.gov.uk](http://www.northamptonshire.gov.uk)



---

**From:** Bill Edwards [<mailto:bedwards@northampton.gov.uk>]  
**Sent:** 03 August 2012 14:23  
**To:** Licensing-NRCS; Paul Mallard; Planning; 'stephen.horsley@northants.nhs.uk'; 'licensing-mailbox@northantsfire.org.uk'; Lee Hunter; licensing; 'Bryan David'  
**Subject:** Licence Variation Application - 124 Wellingborough Rd, Northampton & New Premises License Application - Kailash, 161 Kettering Rdn Northampton

### Licensing Act 2003

On the 3<sup>rd</sup> August 2012 we received a postal application from Personal License Training Ltd on behalf of Danny Kituno in relation to a **Variation of a Premises Licence** in respect of **The New Bar Serengeti, 124 Wellingborough Rd, Northampton** of which you should have been served a copy.

The last date for representations is the 30<sup>th</sup> August 2012 should you have any objections to the application.

Today, we have also received an application for a premises license from D.W. Solicitors in respect of **Kailash, 161 Kettering Rd, Northampton** of which you should also have been served a copy.

The last date for representations is also 30<sup>th</sup> August 2012.

Regards

Bill Edwards  
Senior Licensing Officer  
Northampton Borough Council  
01604 838986

Please note that the contents of this e-mail, including any attachments thereto, may contain information which is confidential or privileged, and which is solely for the use of the recipient named above. The information contained in this e-mail, and in your reply, may be subject to disclosure under the Freedom of Information Act 2000 or other legislation, and its confidentiality cannot be guaranteed. If you are not the intended recipient, please be aware that any disclosure, copying, distribution or use of the contents of this e-mail is strictly prohibited. Northampton Borough Council, The Guildhall, Northampton, United Kingdom, NN1 1DE +44 (0)300 330 7000 [www.northampton.gov.uk](http://www.northampton.gov.uk)

-----  
This e-mail and any files transmitted with it are intended solely for the use of the individual or organisation to whom they are addressed. If you have received this e-mail in error, please notify the sender either by return of e-mail or by ringing the County Council's main switchboard on (0)300 1261000.

The information contained in this e-mail and in your reply may be subject to disclosure under the Freedom of Information Act 2000 or other legislation and its confidentiality cannot be guaranteed.

This e-mail has been checked for the presence of computer viruses.  
Northamptonshire County Council. <http://www.northamptonshire.gov.uk>  
-----

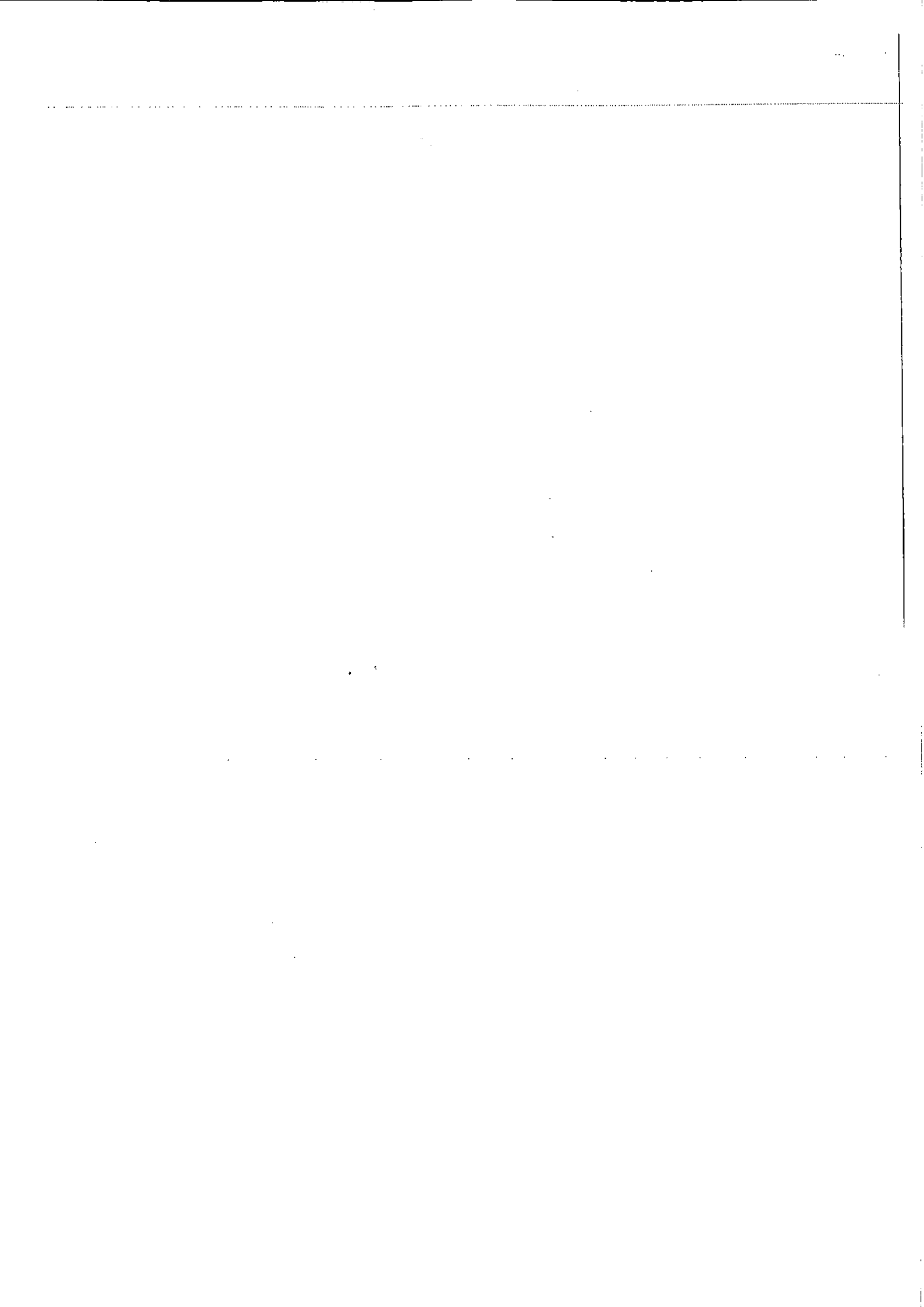

Licensing Act 2003  
**Premises Licence**

**PL0002**

**LOCAL AUTHORITY**



**Licensing Section  
 The Guildhall  
 St Gles Square  
 NORTHAMPTON  
 NN1 1DE**

**Part 1 - Premises Details**

**POSTAL ADDRESS OF PREMISES, OR IF NONE, ORDANCE SURVEY MAP REFERENCE OR DESCRIPTION**

**The New Bar Serengeti**

124 Wellingborough Road, Northampton, NN1 4DR.

Telephone 01604 635800

**WHERE THE LICENCE IS TIME LIMITED THE DATES**

Not applicable

**LICENSABLE ACTIVITIES AUTHORISED BY THE LICENCE**

- any playing of recorded music
- entertainment facilities for making music
- the sale by retail of alcohol

**THE TIMES THE LICENCE AUTHORIZES THE CARRYING OUT OF LICENSABLE ACTIVITIES**

Activity (and Area if applicable)	Description	Time From	Time To	
F. Playing of recorded music (Indoors)	Monday-Thursday	10:00am	11:00pm	
	Friday-Saturday	10:00am	Midnight	
	Sunday	Noon	11:00pm	
I. Provision of facilities for making music (Indoors)	Monday-Thursday	10:00am	11:00pm	
	Friday-Saturday	10:00am	Midnight	
	Sunday	Noon	11:00pm	
M. The sale by retail of alcohol for consumption ON and OFF the premises	Monday-Thursday	10:00am	11:00pm	
	Friday-Saturday	10:00am	Midnight	
	Sunday	Noon	11:00pm	
	Non Standard Timings:			
	1st January; 2nd January; 14th February (St Valentine's Day) Easter Bank Holiday (Sun & Mon) May Bank Holiday (Sun & Mon); May Bank Holiday (Sun & Mon); Spring Bank Holiday (Sun & Mon); Summer Bank Holiday (Sun & Mon); Christmas Eve; Boxing Day; 27th December: All above from 10:00 to 24:00 hours.			
	18th April: Zimbabwe Independence Day; 5th October: Nigerian Independence Day; 10th October: Ugandan Independence Day; 12th December Kenyan Independence Day: All above from 10:00 to 01:00 hours.			

**THE OPENING HOURS OF THE PREMISES**

Description	Time From	Time To
-------------	-----------	---------



## Premises Licence

## THE OPENING HOURS OF THE PREMISES continued ...

Description	Time From	Time To
Monday-Thursday	10:00am	11:30pm
Friday-Saturday	10:00am	12:30am
Sunday	Noon	11:30pm

## Non Standard Timings:

1st January; 2nd January: 14th February (St Valentine's Day); Easter Bank Holiday (Sun & Mon); May Bank Holiday (Sun & Mon); Spring Bank Holiday (Sun & Mon); Summer Bank Holiday (Sun & Mon); Christmas Eve; Boxing Day; 27th December: All above from 10:00 to 00:30 hours.

18th April: Zimbabwe Independence Day; 5th October: Nigerian Independence Day; 10th October: Ugandan Independence Day; 12th December Kenyan Independence Day: All above from 10:00 to 01:30 hours.

## WHERE THE LICENCE AUTHORISES SUPPLIES OF ALCOHOL WHETHER THESE ARE ON AND / OR OFF SUPPLIES

- M. The sale by retail of alcohol for consumption ON and OFF the premises

## Part 2

## NAME, (REGISTERED) ADDRESS, TELEPHONE NUMBER AND EMAIL, (WHERE RELEVANT) OF HOLDER OF PREMISES LICENCE

Dan Mandaba Kituno

The New Bar Serengetti, 124 Wellingborough Road, Northampton, NN1 4DR.

## REGISTERED NUMBER OF HOLDER, FOR EXAMPLE COMPANY NUMBER, CHARITY NUMBER (WHERE APPLICABLE)

## NAME, ADDRESS AND TELEPHONE NUMBER OF DESIGNATED PREMISES SUPERVISOR WHERE THE PREMISES LICENCE AUTHORISES THE SUPPLY OF ALCOHOL

Dan Mandaba KITUNO

The New Bar Serengetti, 124 Wellingborough Road, Northampton, NN1 4DR.

## PERSONAL LICENCE NUMBER AND ISSUING AUTHORITY OF PERSONAL LICENCE HELD BY DESIGNATED PREMISES SUPERVISOR WHERE THE PREMISES LICENCE AUTHORISES FOR THE SUPPLY OF ALCOHOL

Licence No. PA2090

Issued by Northampton

## ANNEXES

## ANNEX 1 - MANDATORY CONDITIONS

## 19 Mandatory conditions where licence authorises supply of alcohol

(1) No supply of alcohol may be made under the premises licence -

(a) at a time when there is no designated premises supervisor in respect of the premises licence, or

(b) at a time when the designated premises supervisor does not hold a personal licence or his personal licence is suspended.

(2) Every supply of alcohol under the premises licence must be made or authorised by a person who holds a personal licence.





ANNEXES continued...

**Condition relating to the Prevention of Public Nuisance**

- 3.3 The Licensee shall ensure that the volume of noise due to music and singing (and fixed plant equipment) shall be so controlled by the Licensee so as not to give reasonable cause for annoyance. Notwithstanding the above any noise shall not be audible within any noise sensitive buildings.

Where this has been breached the Licensee will review the noise control measures that are in place and implement a revised scheme that has been agreed with the Licensing Authority.

**ADDITIONAL MANDATORY CONDITIONS.**

The following mandatory conditions are to be applied to the licence stated above in accordance with section 3 (1) of The Licensing Act 2003 (Mandatory Licensing Conditions) Order 2010.

**The following conditions shall come into force on 6th April 2010**

1. (1) The responsible person shall take all reasonable steps to ensure that staff on relevant premises do not carry out, arrange or participate in any irresponsible promotions in relation to the premises.

(2) In this paragraph, an irresponsible promotion means any one or more of the following activities, or substantially similar activities, carried on for the purpose of encouraging the sale or supply of alcohol for consumption on the premises in a manner which carries a significant risk of



**Premises Licence**

## ANNEXES continued...

leading or contributing to crime and disorder, prejudice to public safety, public nuisance, or harm to children-

(a) games or other activities which require or encourage, or are designed to require or encourage, individuals to-

(i) drink a quantity of alcohol within a time limit (other than to drink alcohol sold or supplied on the premises before the cessation of the period in which the responsible person is authorised to sell or supply alcohol), or

(ii) drink as much alcohol as possible (whether within a time limit or otherwise);

(b) provision of unlimited or unspecified quantities of alcohol free or for a fixed or discounted fee to the public or to a group defined by a particular characteristic (other than any promotion or discount available to an individual in respect of alcohol for consumption at a table meal, as defined in section 159 of the Act;

(c) provision of free or discounted alcohol or any other thing as a prize to encourage or reward the purchase and consumption of alcohol over a period of 24 hours or less;

(d) provision of free or discounted alcohol in relation to the viewing on the premises of a sporting event, where that provision is dependent on-

(i) the outcome of a race, competition or other event or process, or

(ii) the likelihood of anything occurring or not occurring;

(e) selling or supplying alcohol in association with promotional posters or flyers on, or in the vicinity of, the premises which can reasonably be considered to condone, encourage or glamorise anti-social behaviour or to refer to the effects of drunkenness in any favourable manner.

2. The responsible person shall ensure that no alcohol is dispensed directly by one person into the mouth of another (other than where that other person is unable to drink without assistance by reason of a disability).

3. The responsible person shall ensure that free tap water is provided on request to customers where it is reasonably available.

The following mandatory conditions are to be applied to the licence stated above in accordance with section 3 (1) of The Licensing Act 2003 (Mandatory Licensing Conditions) Order 2010.

**The following conditions shall come into force on 1st October 2010**

4. (1) The premises licence holder or club premises certificate holder shall ensure that an age verification policy applies to the premises in relation to the sale or supply of alcohol.

(2) The policy must require individuals who appear to the responsible person to be under 18 years of age (or such older age as may be specified in the policy) to produce on request, before being served alcohol, identification bearing their photograph, date of birth and a holographic mark.



ANNEXES continued

5. The responsible person shall ensure that-

(a) where any of the following alcoholic drinks is sold or supplied for consumption on the premises (other than alcoholic drinks sold or supplied having been made up in advance ready for sale or supply in a securely closed container) it is available to customers in the following measures-

- (i) beer or cider: 1/2 pint;
- (ii) gin, rum, vodka or whisky: 25 ml or 35 ml; and
- (iii) still wine in a glass: 125 ml; and

(b) customers are made aware of the availability of these measures.

**F. FERNANDES**

Solicitor to the Council



## Premises Licence Summary

## LOCAL AUTHORITY



Licensing Section  
The Guildhall  
St Giles Square  
NORTHAMPTON  
NN1 1DE

## Premises Details

## POSTAL ADDRESS OF PREMISES, OR IF NONE, ORDNANCE SURVEY MAP REFERENCE OR DESCRIPTION

**The New Bar Serengeti**

124 Wellingborough Road, Northampton, NN1 4DR.

Telephone 01604 835800

## WHERE THE LICENCE IS TIME LIMITED THE DATES

Not applicable

## LICENSABLE ACTIVITIES AUTHORISED BY THE LICENCE

- any playing of recorded music
- entertainment facilities for making music
- the sale by retail of alcohol

## THE TIMES THE LICENCE AUTHORISES THE CARRYING OUT OF LICENSABLE ACTIVITIES

Activity (and Area if applicable)	Description	Time From	Time To
F. Playing of recorded music (Indoors)	Monday-Thursday	10:00am	11:00pm
	Friday-Saturday	10:00am	Midnight
	Sunday	Noon	11:00pm
I. Provision of facilities for making music (Indoors)	Monday-Thursday	10:00am	11:00pm
	Friday-Saturday	10:00am	Midnight
	Sunday	Noon	11:00pm
M. The sale by retail of alcohol for consumption ON and OFF the premises	Monday-Thursday	10:00am	11:00pm
	Friday-Saturday	10:00am	Midnight
	Sunday	Noon	11:00pm
	Non Standard Timings:		
1st January: 2nd January: 14th February (St Valentine's Day) Easter Bank Holiday (Sun & Mon) May Bank Holiday (Sun & Mon): May Bank Holiday (Sun & Mon): Spring Bank Holiday (Sun & Mon): Summer Bank Holiday (Sun & Mon): Christmas Eve: Boxing Day: 27th December: All above from 10:00 to 24:00 hours.			
18th April: Zimbabwe Independence Day: 5th October: Nigerian Independence Day: 10th October: Ugandan Independence Day: 12th December Kenyan Independence Day: All above from 10:00 to 01:00 hours.			

## THE OPENING HOURS OF THE PREMISES

Description	Time From	Time To
-------------	-----------	---------



## Premises Licence Summary

THE OPENING HOURS OF THE PREMISES *continued*

Description	Time From	Time To
Monday-Thursday	10:00am	11:30pm
Friday-Saturday	10:00am	12:30am
Sunday	Noon	11:30pm

## Non Standard Timings:

1st January: 2nd January: 14th February (St Valentine's Day): Easter Bank Holiday (Sun & Mon): May Bank Holiday (Sun & Mon): Spring Bank Holiday (Sun & Mon): Summer Bank Holiday (Sun & Mon): Christmas Eve: Boxing Day: 27th December: All above from 10:00 to 00:30 hours.

18th April: Zimbabwe Independence Day: 5th October: Nigerian Independence Day: 10th October: Ugandan Independence Day: 12th December Kenyan Independence Day: All above from 10:00 to 01:30 hours.

## WHERE THE LICENCE AUTHORISES SUPPLIES OF ALCOHOL WHETHER THESE ARE ON AND / OR OFF SUPPLIES

- M. The sale by retail of alcohol for consumption ON and OFF the premises

## NAME, (REGISTERED) ADDRESS OF HOLDER OF PREMISES LICENCE

Dan Mandaba Kituno

The New Bar Serengeti, 124 Wellingborough Road, Northampton, NN1 4DR.

## REGISTERED NUMBER OF HOLDER, FOR EXAMPLE COMPANY NUMBER, CHARITY NUMBER (WHERE APPLICABLE)

## NAME OF DESIGNATED PREMISES SUPERVISOR WHERE THE PREMISES LICENCE AUTHORISES THE SUPPLY OF ALCOHOL

Dan Mandaba KITUNO

## STATE WHETHER ACCESS TO THE PREMISES BY CHILDREN IS RESTRICTED OR PROHIBITED



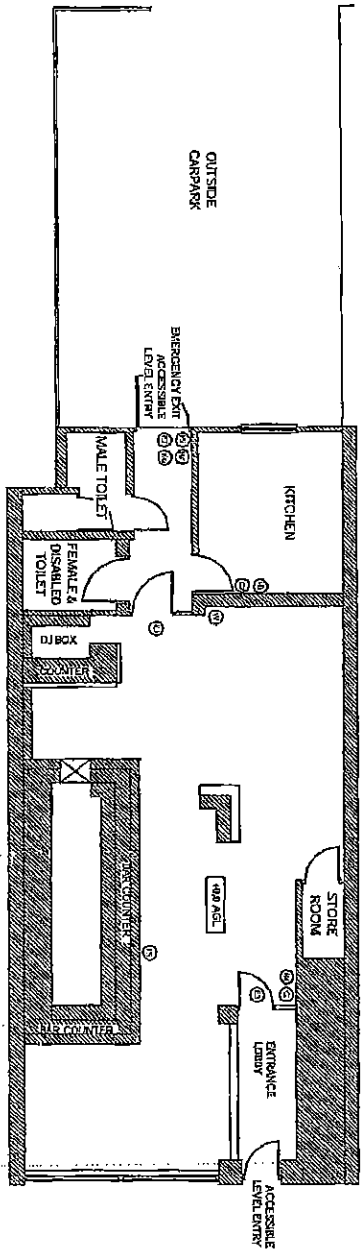

**EXISTING GROUND FLOOR PLAN**  
Scale 1:100

**KEY**

- ① GAS CARTRIDGE EXTINGUISHER
- ② WATER EXTINGUISHER
- ③ CO2 EXTINGUISHER
- ④ ILLUMINATED EXIT SIGN WITH DIRECTIONAL ARROW
- ⑤ NON-ILLUMINATED EXIT SIGN WITH DIRECTIONAL ARROW
- ⑥ FIRE BLANKET
- ⑦ FIRE SHELVE
- ⑧ BREAK GLASS

**DO NOT SCALE FROM THIS DRAWING**  
 ANY DIMENSIONS TO BE NOTIFIED TO THE SURVEYOR  
 AT THE SIGNATURE OF THE SURVEYOR TO BE VALID FOR THE SURVEYOR'S DESIGN ACCEPTANCE AND LIABILITY FOR THE ACCURACY OF DRAWINGS / MEASUREMENTS FROM THIRD PARTIES.  
 1) DO NOT SCALE EXCEPT FOR PLANNING PURPOSES. USE MEASURED DIMENSIONS TO BE OBTAINED ON SITE BEFORE COMMENCEMENT OF WORK.  
 2) WHERE APPLICABLE THIS DRAWING SHOULD BE READ IN CONJUNCTION WITH OTHER CONSULTANT'S DRAWINGS.  
 3) PLEASE CHECK THAT THE DRAWING IS OF THE LATEST REVISION BY CHECKING THE DRAWING REGISTER SHEET.  
 4) IF FOR ANY REASON THE NAMED ITEMS NOT AVAILABLE THE INTEREST AND MOST SUITABLE ITEMS TO BE EMPLOYED.  
 5) THIS DRAWING IS THE COPYRIGHT OF TJS DESIGN.

Row	Level	Details	Drawn

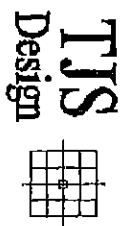

35 Tuba Way, Ballycotton, Northampton,  
 NN1 5NY  
 Tel/Fax: 01604 833174  
 E-Mail: tjs\_design@btconnect.com

Project Title  
**Bar Serengeti**  
 124 Wellingsborough Road  
 Northampton  
 Northamptonshire  
 NN4 4DR

Existing Floor Plans	Scale	1:100
Drawn	Drawn	28 FEBRUARY 2005
SS	Checked	TJS
		28 FEB 2005
		13/01/2002

Approved  
 TJS Design  
 Design  
 TJS Design  
 Design

Drawing No.  
**TJS/PL002**

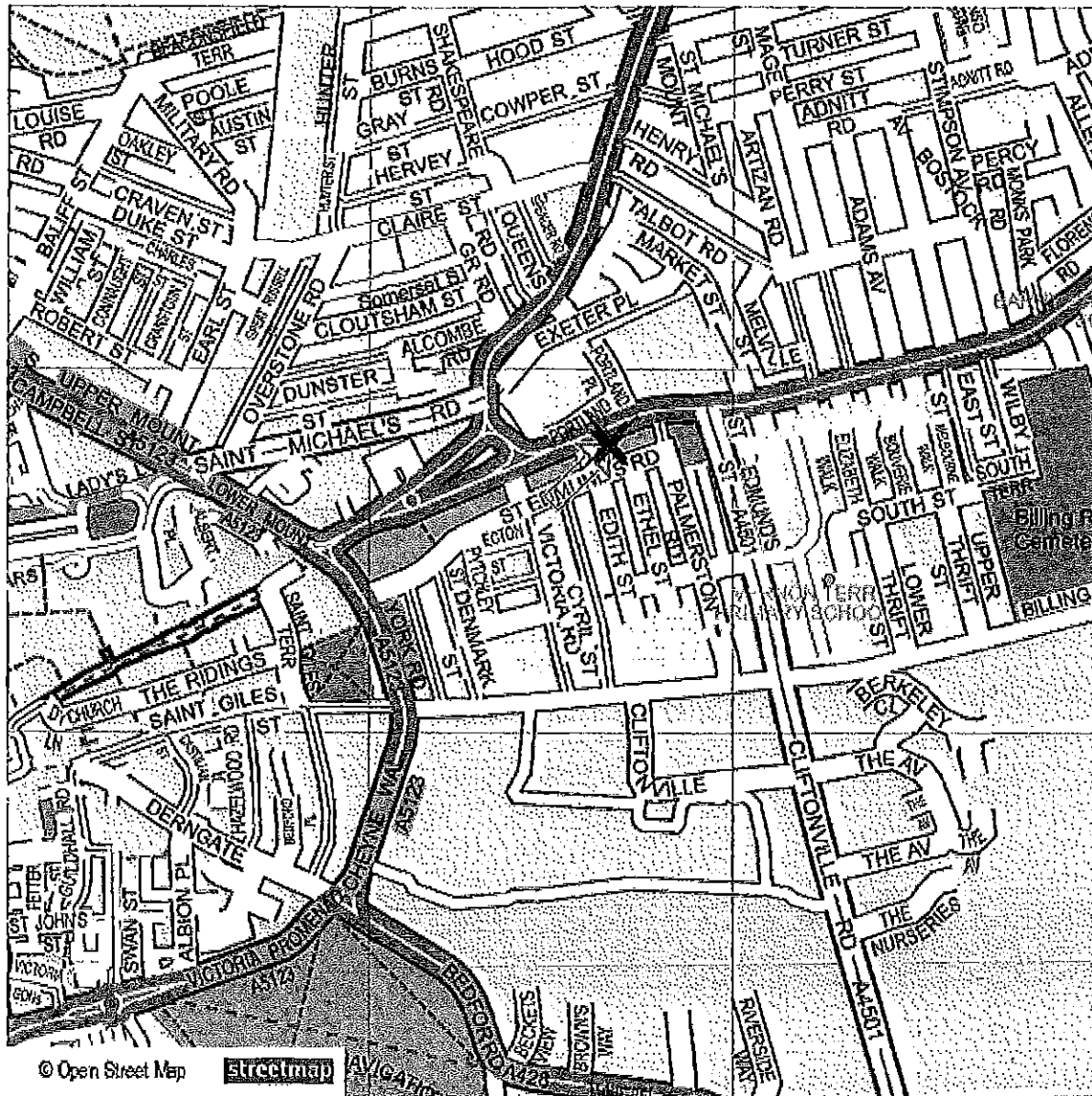

© Open Street Map **Streetmap**  
This product includes mapping data licensed from Ordnance Survey  
[Click here for a larger map](#)